

454 3/4" Control Flow Brine Valve

with 5 GPM Brine Line Refill Flow Control

454 3/4" CONTROL FLOW BRINE VALVE WITH 5 GPM BRINE LINE REFILL FLOW CONTROL

Today's larger commercial brine valves demand higher brine draw and refill rates. Building upon the original 454's design, the 454 3/4" Control Flow has improved flow characteristics allowing brine draw up to 10 gallons per minute and refill rates up to five gallons per minute. A flow diffuser, heavier float, and brine line refill flow control prevent premature checking.

Maximum Operating Pressure: 125 psig (862 kPa)
Temperature Range: 40-110°F (4-43°C)

36" and 54" Float Rods are available.
Please specify length as listed below:

H7070-36CF-5 - 454 3/4" Control Flow Brine Valve with 5 GPM Brine Line Refill Flow Control (36" Rod)

H7070-54CF-5 - 454 3/4" Control Flow Brine Valve with 5 GPM Brine Line Refill Flow Control (54" Rod)

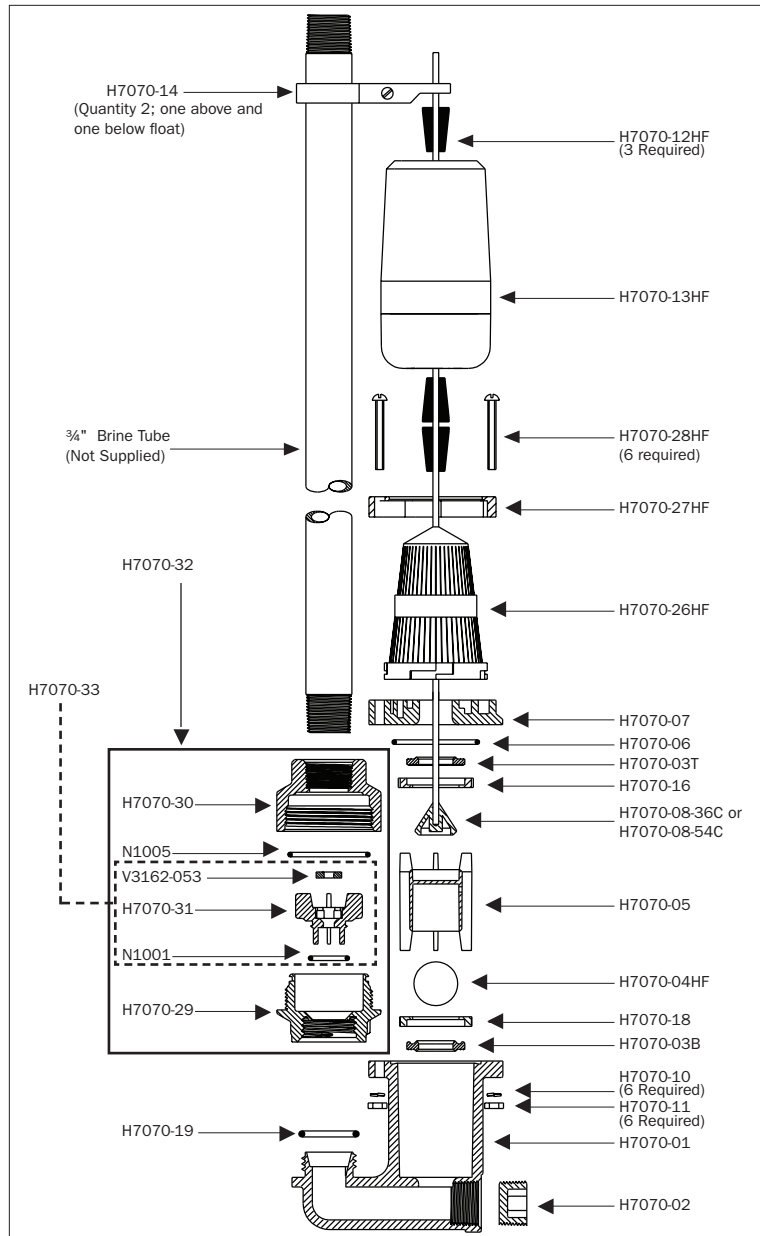
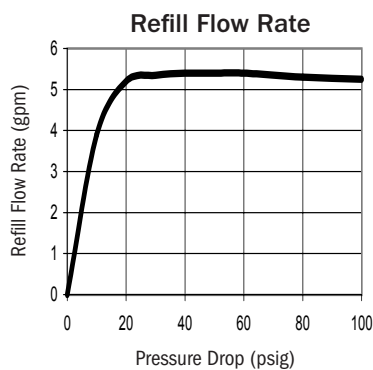
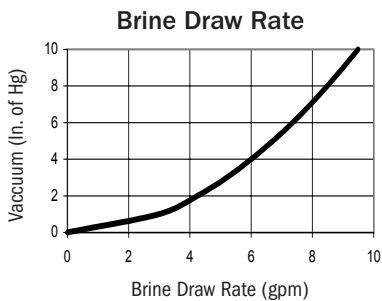

Order Information:

ORDER NUMBER	DESCRIPTION	ORDER NUMBER	DESCRIPTION
H7070-01	Body	H7070-16	Upper Seat Retainer
H7070-02	Plastic Plug 3/4"	H7070-18	Lower Seat Retainer
H7070-03T	Seat Washer Top (Orange)	H7070-19	O-ring Refill Chamber Seal
H7070-03B	Seat Washer Bottom (Clear)	H7070-26HF	Basket Diffuser
H7070-04HF	High Flow Air Check Ball	H7070-27HF	Retainer Ring
H7070-05	Ball Cage	H7070-28HF	SS HF Screw
H7070-06	O-rine Cover Seal	H7070-29	Refill Flow Control Base
H7070-07	Body Cover	H7070-30	Refill Flow Control Body
H7070-08-36C	Float Rod and Seat Cone Asy - 36"	H7070-31	Refill Flow Control Retainer
H7070-08-54C	Float Rod and Seat Cone Asy - 54"	H7070-32	Refill Flow Control Asy
H7070-10	SS Lock Washer	H7070-33	Refill Flow Control Retainer Asy
H7070-11	SS Nut	N1001	O-ring 115
H7070-12HF	High Flow Float Grommet	N1005	O-ring 130
H7070-13HF	High Flow Float	V3162-053	Refill Flow Control Washer
H7070-14	Float Rod Guide Asy		

NOTE: The 454 3/4" Control Flow Brine Valve is designed for salt brine only. It will also fit inside a brine well that is 5" or larger.

454 3/4" Control Flow Brine Valve with 5 GPM Brine Line Refill Flow Control Installation Guide

1. Use Teflon tape only on threaded plastic pipe connections. Many liquid or paste pipe sealing products contain compounds that may cause plastics to crack with time.
2. PVC brine pipe is recommended for use with these valves as it is non-corrosive and threads easily.
3. After the proper float setting has been determined and the height set, place the float rod guides close to the float (but not as to hinder float operation), adjust to position the float directly above the brine valve and tighten securely.
4. Position the assembly securely in the brine well and check to see that there is no interference with the float operation.

NOTE: This brine valve is intended to be used as a safety float only for timed brine systems! Repeated float closures at high refill rates can cause "water hammer," which may damage the plumbing. For non-timed brine systems, use the 454 3/4" Standard Brine Valve.

Order No: H7070-34
Description: 454 Brine Valve Seal
Replacement Kit

ORDER NUMBER	DESCRIPTION
H7070-03T	Seat Washer Top (Orange)
H7070-03B	Seat Washer Bottom (Clear)
H7070-06	O-ring Cover Seal
H7070-16	Upper Seat Retainer
H7070-18	Lower Seat Retainer
H7070-19	O-ring Refill Chamber Seal