

Order No. **V3007-10**

Description: **WS1 Fitting 3/4" PEX Assembly**

Drawing No.	Order No.	Description	Quantity
1	V3151	WS1 Nut 1" Quick Connect	2
2	V3150	WS1 Split Ring	2
3	V3105	O-Ring 215	2
4	V3535	WS1 Fitting 3/4" PEX	2

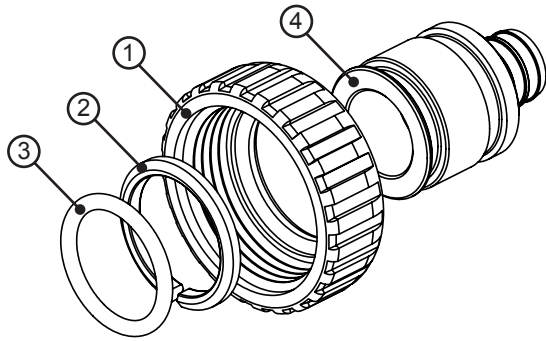

Form No. V3115-26 • 11/04/2014

Order No. **V3007-10**

Description: **WS1 Fitting 3/4" PEX Assembly**

Drawing No.	Order No.	Description	Quantity
1	V3151	WS1 Nut 1" Quick Connect	2
2	V3150	WS1 Split Ring	2
3	V3105	O-Ring 215	2
4	V3535	WS1 Fitting 3/4" PEX	2

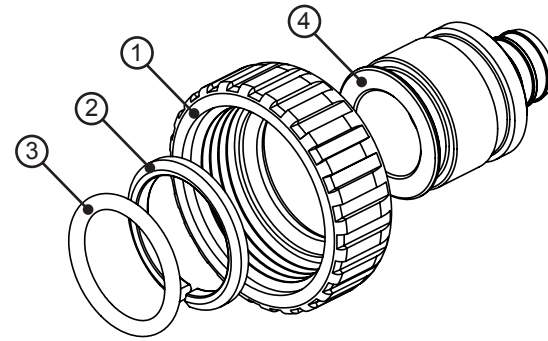

Form No. V3115-26 • 11/04/2014

Order No. **V3007-10**

Description: **WS1 Fitting 3/4" PEX Assembly**

Drawing No.	Order No.	Description	Quantity
1	V3151	WS1 Nut 1" Quick Connect	2
2	V3150	WS1 Split Ring	2
3	V3105	O-Ring 215	2
4	V3535	WS1 Fitting 3/4" PEX	2

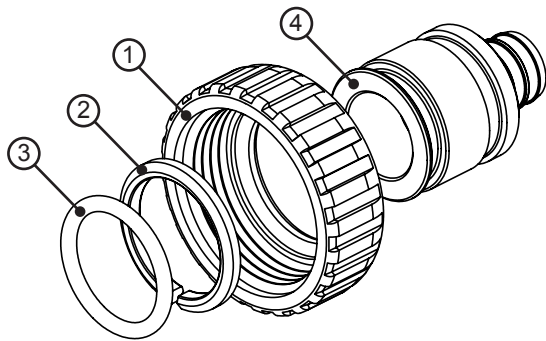

Form No. V3115-26 • 11/04/2014

Order No. **V3007-10**

Description: **WS1 Fitting 3/4" PEX Assembly**

Drawing No.	Order No.	Description	Quantity
1	V3151	WS1 Nut 1" Quick Connect	2
2	V3150	WS1 Split Ring	2
3	V3105	O-Ring 215	2
4	V3535	WS1 Fitting 3/4" PEX	2

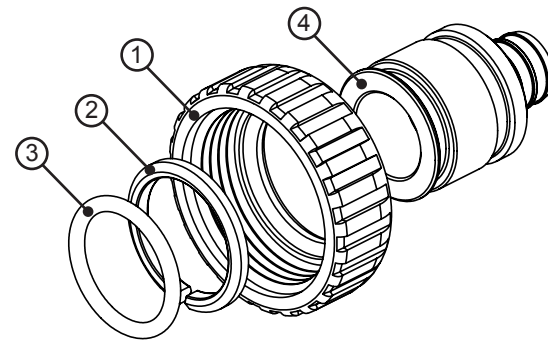

Form No. V3115-26 • 11/04/2014

Order No. **V3007-10**

Description: **WS1 Fitting 3/4" PEX Assembly**

Fitting Installation Instructions

- Installation fittings are designed to accommodate minor plumbing misalignments, but are not designed to support the weight of a system or the plumbing.
- Use a **copper** crimp ring, crimping tool, and measuring tool and follow assembly and measuring procedures recommended by the PEX tubing manufacturer. The metal fitting has been designed to meet the criteria in ASTM F1807 entitled: "Metal Insert Fittings Using a Copper Crimp Ring for SDR9 Cross-linked Polyethylene (PEX) Tubing".
- Slide nut on first, then the split ring and o-ring.
- Hand tighten the nut only.

NOTE: Has not been tested for compliance with California Proposition 65, so this fitting should not be installed in California.

Form No. V3115-26 • 11/04/2014

Order No. **V3007-10**

Description: **WS1 Fitting 3/4" PEX Assembly**

Fitting Installation Instructions

- Installation fittings are designed to accommodate minor plumbing misalignments, but are not designed to support the weight of a system or the plumbing.
- Use a **copper** crimp ring, crimping tool, and measuring tool and follow assembly and measuring procedures recommended by the PEX tubing manufacturer. The metal fitting has been designed to meet the criteria in ASTM F1807 entitled: "Metal Insert Fittings Using a Copper Crimp Ring for SDR9 Cross-linked Polyethylene (PEX) Tubing".
- Slide nut on first, then the split ring and o-ring.
- Hand tighten the nut only.

NOTE: Has not been tested for compliance with California Proposition 65, so this fitting should not be installed in California.

Form No. V3115-26 • 11/04/2014

Order No. **V3007-10**

Description: **WS1 Fitting 3/4" PEX Assembly**

Fitting Installation Instructions

- Installation fittings are designed to accommodate minor plumbing misalignments, but are not designed to support the weight of a system or the plumbing.
- Use a **copper** crimp ring, crimping tool, and measuring tool and follow assembly and measuring procedures recommended by the PEX tubing manufacturer. The metal fitting has been designed to meet the criteria in ASTM F1807 entitled: "Metal Insert Fittings Using a Copper Crimp Ring for SDR9 Cross-linked Polyethylene (PEX) Tubing".
- Slide nut on first, then the split ring and o-ring.
- Hand tighten the nut only.

NOTE: Has not been tested for compliance with California Proposition 65, so this fitting should not be installed in California.

Form No. V3115-26 • 11/04/2014

Order No. **V3007-10**

Description: **WS1 Fitting 3/4" PEX Assembly**

Fitting Installation Instructions

- Installation fittings are designed to accommodate minor plumbing misalignments, but are not designed to support the weight of a system or the plumbing.
- Use a **copper** crimp ring, crimping tool, and measuring tool and follow assembly and measuring procedures recommended by the PEX tubing manufacturer. The metal fitting has been designed to meet the criteria in ASTM F1807 entitled: "Metal Insert Fittings Using a Copper Crimp Ring for SDR9 Cross-linked Polyethylene (PEX) Tubing".
- Slide nut on first, then the split ring and o-ring.
- Hand tighten the nut only.

NOTE: Has not been tested for compliance with California Proposition 65, so this fitting should not be installed in California.

Form No. V3115-26 • 11/04/2014