

Order No. **V4242**

Description: **WS1 Fill and Service Microswitch Kit**

Drawing No.	Order No.	Description	Quantity
1	V3301	WS1 MICROSWITCH	1
2	V3302	WS1 MOLEX CONNECTOR	1
Not Shown	V3303	WS1 MOLEX TERMINAL	3
3	V3304	WS1 SCREWS 4/40 X 3/4	2
4	V3305	WS1 RETAINING RING SS 1/4	1
5	V4226	WS1 WASHER FILL AND SERVICE	1

Slip the washer and retaining ring on to the end of the piston rod. Attach the microswitch to the drive bracket using the screws. Attach the connector to the microswitch. Attach the terminals to wires and connect.

Form No. V3115-59 • 2/16/2017

Order No. **V4242**

Description: **WS1 Fill and Service Microswitch Kit**

Drawing No.	Order No.	Description	Quantity
1	V3301	WS1 MICROSWITCH	1
2	V3302	WS1 MOLEX CONNECTOR	1
Not Shown	V3303	WS1 MOLEX TERMINAL	3
3	V3304	WS1 SCREWS 4/40 X 3/4	2
4	V3305	WS1 RETAINING RING SS 1/4	1
5	V4226	WS1 WASHER FILL AND SERVICE	1

Slip the washer and retaining ring on to the end of the piston rod. Attach the microswitch to the drive bracket using the screws. Attach the connector to the microswitch. Attach the terminals to wires and connect.

Form No. V3115-59 • 2/16/2017

Order No. **V4242**

Description: **WS1 Fill and Service Microswitch Kit**

Drawing No.	Order No.	Description	Quantity
1	V3301	WS1 MICROSWITCH	1
2	V3302	WS1 MOLEX CONNECTOR	1
Not Shown	V3303	WS1 MOLEX TERMINAL	3
3	V3304	WS1 SCREWS 4/40 X 3/4	2
4	V3305	WS1 RETAINING RING SS 1/4	1
5	V4226	WS1 WASHER FILL AND SERVICE	1

Slip the washer and retaining ring on to the end of the piston rod. Attach the microswitch to the drive bracket using the screws. Attach the connector to the microswitch. Attach the terminals to wires and connect.

Form No. V3115-59 • 2/16/2017

Order No. **V4242**

Description: **WS1 Fill and Service Microswitch Kit**

Drawing No.	Order No.	Description	Quantity
1	V3301	WS1 MICROSWITCH	1
2	V3302	WS1 MOLEX CONNECTOR	1
Not Shown	V3303	WS1 MOLEX TERMINAL	3
3	V3304	WS1 SCREWS 4/40 X 3/4	2
4	V3305	WS1 RETAINING RING SS 1/4	1
5	V4226	WS1 WASHER FILL AND SERVICE	1

Slip the washer and retaining ring on to the end of the piston rod. Attach the microswitch to the drive bracket using the screws. Attach the connector to the microswitch. Attach the terminals to wires and connect.

Form No. V3115-59 • 2/16/2017

**Order No. V4242**  
**Description: WS1 Fill and Service Microswitch Kit**

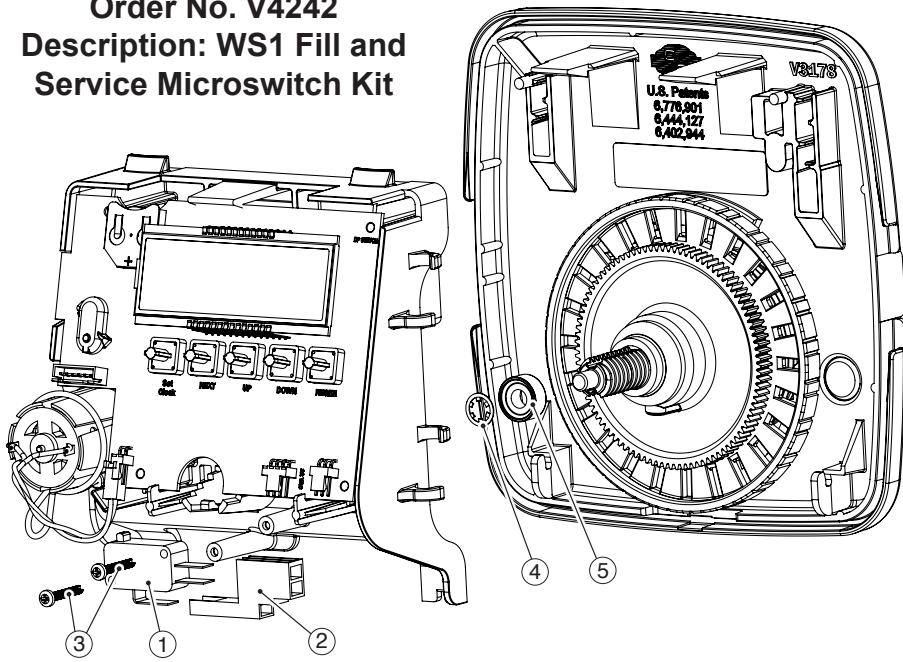

Form No. V3115-59 • 2/16/2017

**Order No. V4242**  
**Description: WS1 Fill and Service Microswitch Kit**

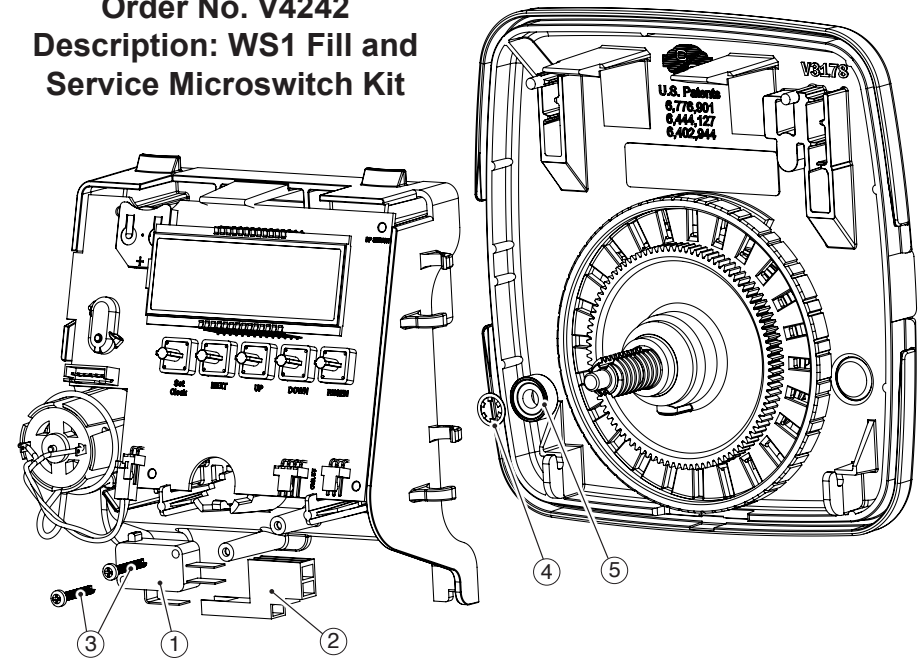

Form No. V3115-59 • 2/16/2017

**Order No. V4242**  
**Description: WS1 Fill and Service Microswitch Kit**

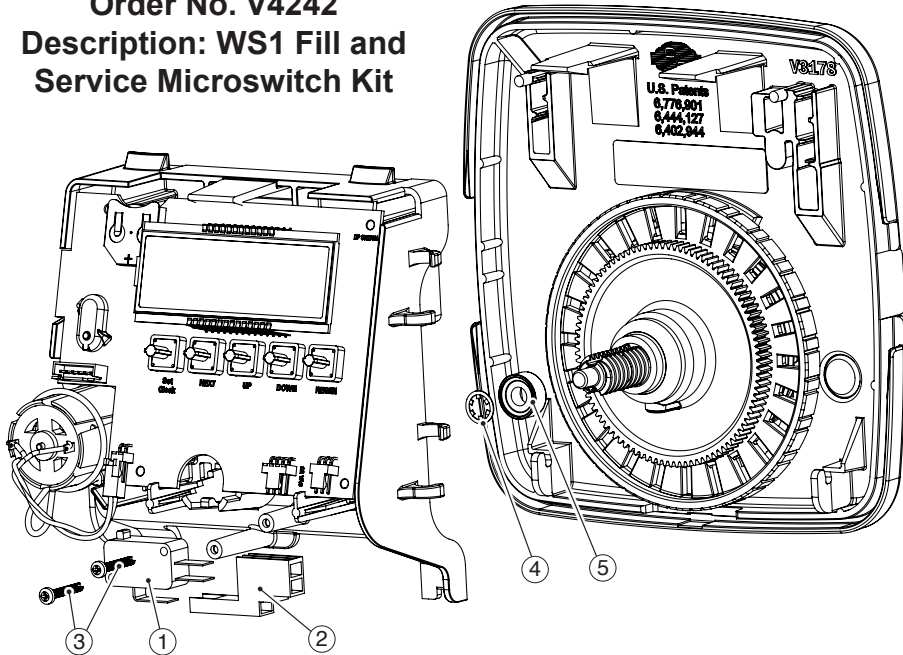

Form No. V3115-59 • 2/16/2017

**Order No. V4242**  
**Description: WS1 Fill and Service Microswitch Kit**

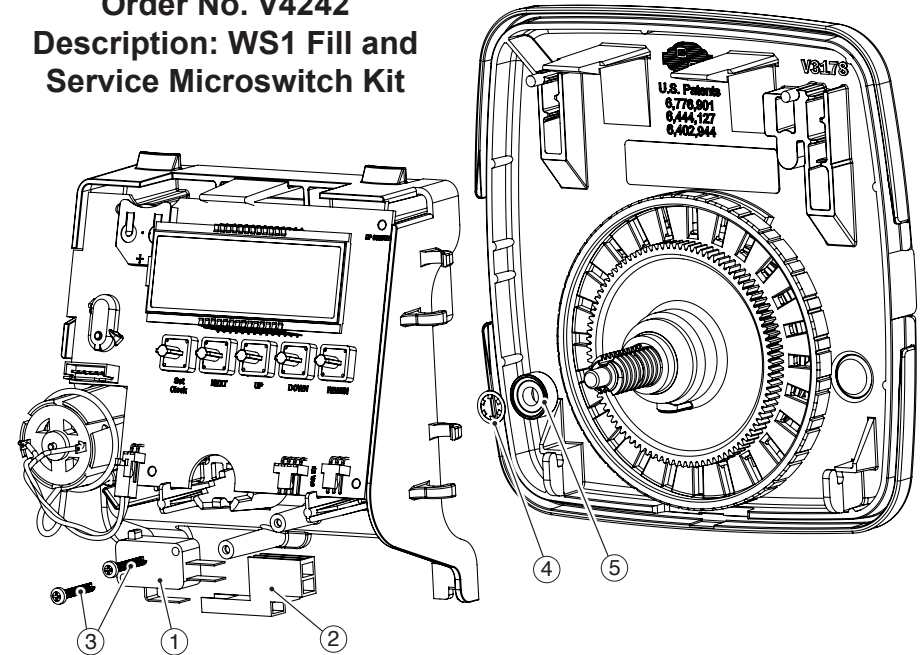

Form No. V3115-59 • 2/16/2017